

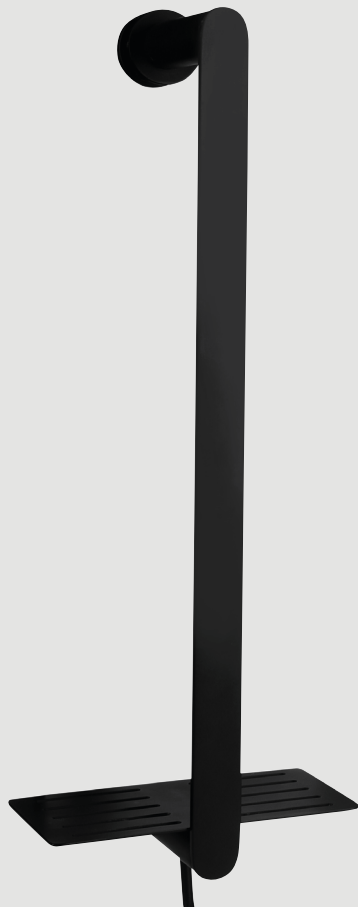

T319661
T319662

Montage- und Bedienungsanleitung • Instruction-manual • Notice de montage et d'utilisation • Montage en bedieningshandleiding • Istruzioni di montaggio e d'uso • Instrucciones de montaje y empleo • Instruções de montagem e operação • Návod k montáži a obsluze • Návod na montáž a obsluhu • Instrukcja montażu i obsługi • Navodilo za montažo in uporabo • Asennus- ja käyttöohje

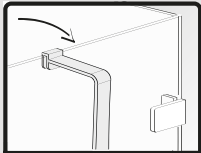



Duschkabine

- (D)** • Zum Einhängen an der Duschkabine bis 8 mm Glasstärke
- (GB)** • For suspension on shower cubicles with up to 8 mm glass strength
- (F)** • Pour accrocher à la cabine de douche jusqu'à 8 mm d'épaisseur de verre
- (NL)** • Om aan de douchecabine te hangen (glassterkte tot 8 mm)
- (I)** • Da appendere alla cabina doccia con vetro dallo spessore massimo di 8mm.
- (E)** • Para colgar en una cabina de ducha con vidrio de hasta 8 mm de espesor
- (P)** • Para pendurar numa cabina de duche com uma espessura de vidro até 8 mm
- (CZ)** • Pro zavěšení na sprchovou kabinu s tloušťkou skla do 8 mm
- (SK)** • Na zavesenie na sprchovú kabinu s hrúbkou skla do 8 mm
- (PL)** • Do zawieszania na kabinie prysznicowej o grubości szyby do 8 mm
- (SLO)** • Za obešanje na tuš kabino z debelino stekla do 8 mm
- (FIN)** • Ripustettäväksi suihku kaappiin, jonka lasivahvuus on ainakin 8 mm
- (RO)** • Pentru suspendare de cabina de duș cu o grosime a geamului de până la 8 mm

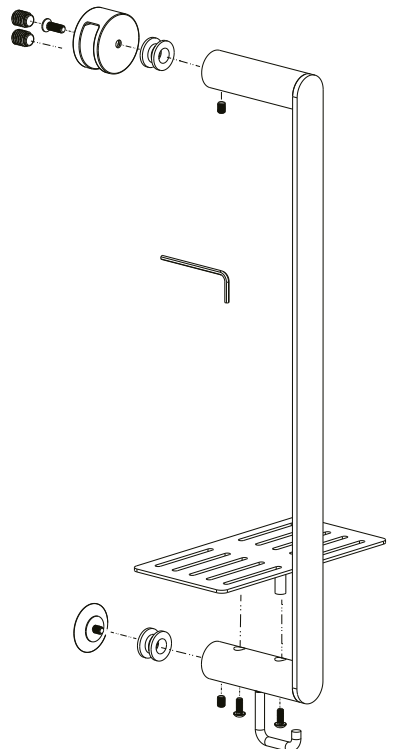
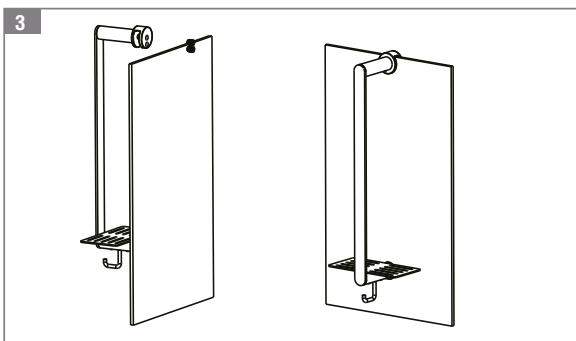
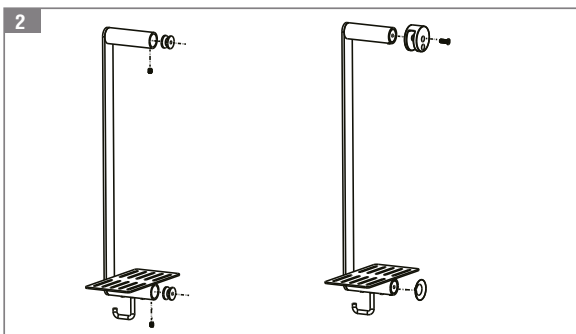
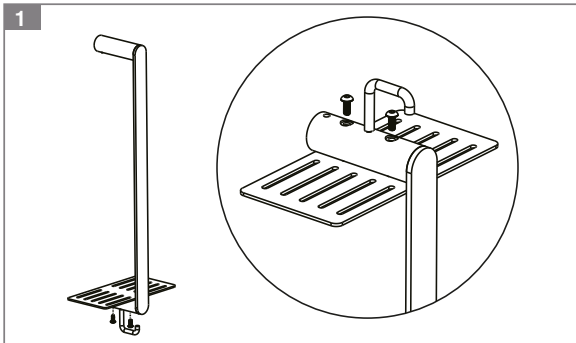

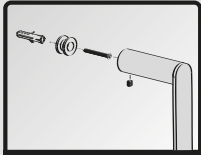

Wandmontage

- (D)** • Auch zur Wandmontage geeignet
- (E)** • Apto también para montaje en pared
- (SLO)** • Primerno tudi za montažo na zid
- (GB)** • Can also be mounted to the wall
- (P)** • Também adequado para montagem na parede
- (FIN)** • Soveltuu myös seinään kiinnitettäväksi
- (F)** • Convient également à un montage mural
- (CZ)** • Vhodné také k montáži na stěnu
- (RO)** • Adecvat și pentru montarea pe perete
- (NL)** • Ook geschikt voor wand montage
- (SK)** • Vhodné aj na montáž na stenu
- (I)** • Adatto anche per il montaggio a parete
- (PL)** • Również do montażu ściennego

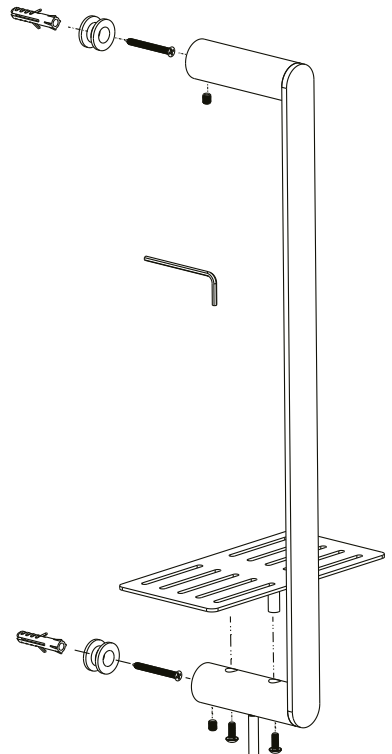
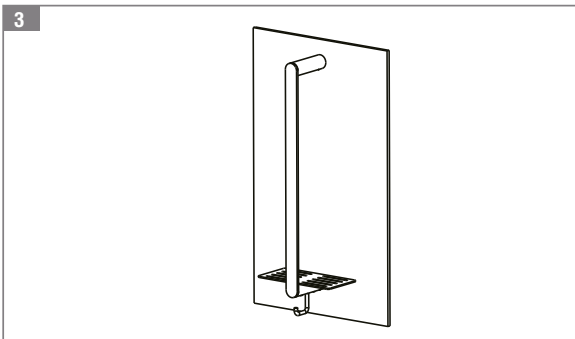
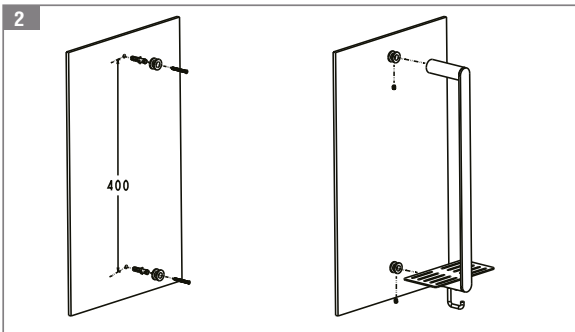
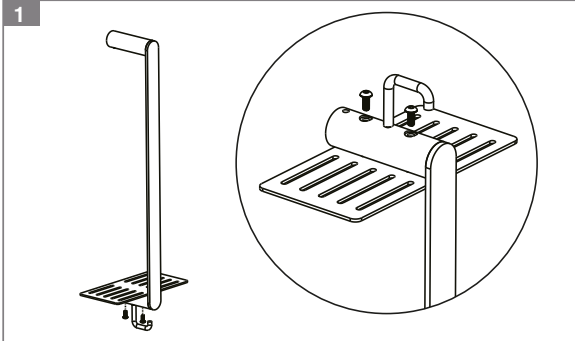

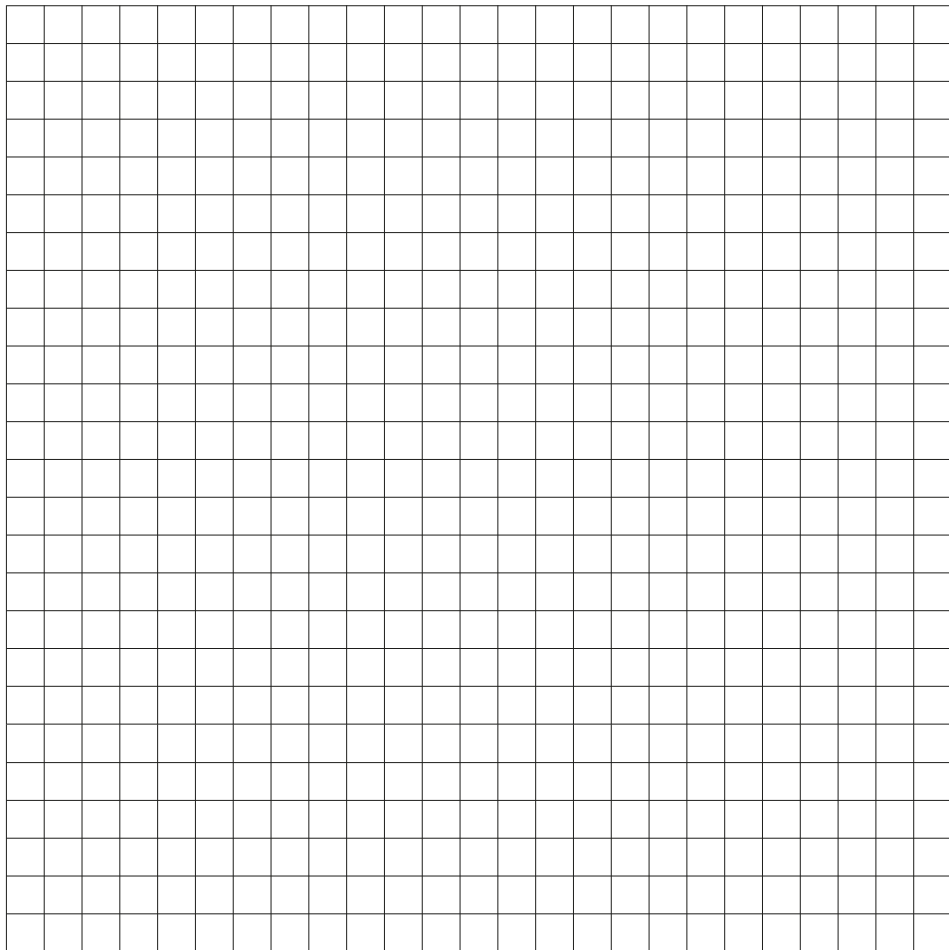

Chargennummer:
Batch number:
Numéro de lot:
Lotnummer:
Numero di lotto:
Número de lote:
Číslo šarže:
Številka veliko:
Numer partii:
Eränumero:

11/2020

AN